

|             |        |       |     |
|-------------|--------|-------|-----|
| DRAWING No. |        |       |     |
| 016502      |        |       |     |
| ISSUE       | CHANGE | DATE  | CHK |
| A           |        | 05.09 | FS  |
|             |        |       |     |
|             |        |       |     |

DO NOT SCALE

IF IN DOUBT-ASK

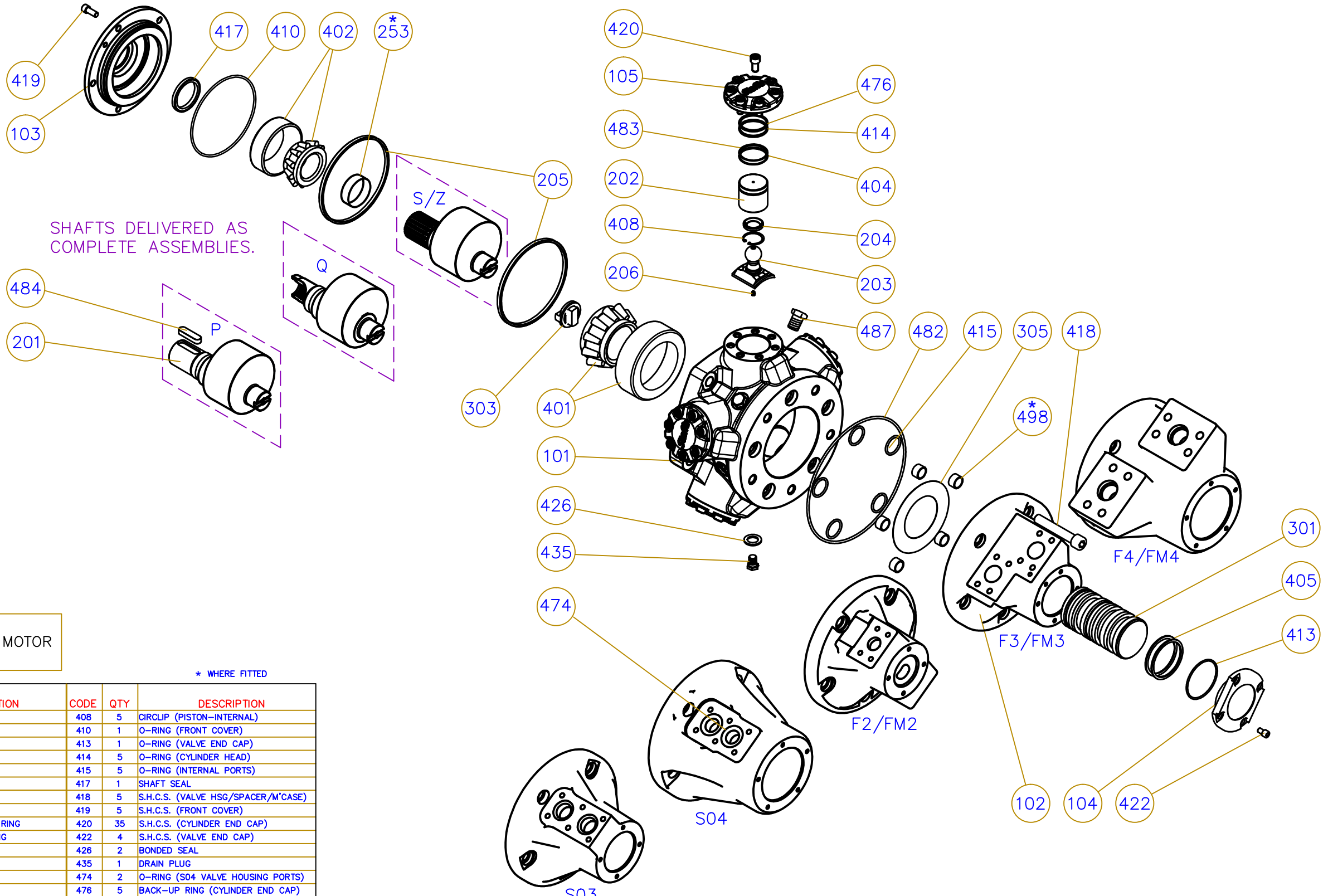

SPARES :  
QUOTE SERIAL NO OF MOTOR  
+ FULL MODEL CODE

\* WHERE FITTED

| CODE  | QTY | DESCRIPTION                | CODE  | QTY | DESCRIPTION                        |
|-------|-----|----------------------------|-------|-----|------------------------------------|
| 101   | 1   | MOTORCASE                  | 408   | 5   | CIRCLIP (PISTON-INTERNAL)          |
| 102   | 1   | VALVE HOUSING              | 410   | 1   | O-RING (FRONT COVER)               |
| 103   | 1   | FRONT COVER                | 413   | 1   | O-RING (VALVE END CAP)             |
| 104   | 1   | VALVE END CAP              | 414   | 5   | O-RING (CYLINDER HEAD)             |
| 105   | 5   | CYLINDER HEAD              | 415   | 5   | O-RING (INTERNAL PORTS)            |
| 201   | 1   | CRANKSHAFT                 | 417   | 1   | SHAFT SEAL                         |
| 202   | 5   | PISTON                     | 418   | 5   | S.H.C.S. (VALVE HSG/SPACER/M'CASE) |
| 203   | 5   | CON-ROD                    | 419   | 5   | S.H.C.S. (FRONT COVER)             |
| 204   | 10  | PISTON RETAINING HALF RING | 420   | 35  | S.H.C.S. (CYLINDER END CAP)        |
| 205   | 2   | CON-ROD RETAINING RING     | 422   | 4   | S.H.C.S. (VALVE END CAP)           |
| 206   | 5   | RESTRICTOR SCREW           | 426   | 2   | BONDED SEAL                        |
| 253 * | 1   | SHAFT SLEEVE               | 435   | 1   | DRAIN PLUG                         |
| 301   | 1   | VALVE SPOOL                | 474   | 2   | O-RING (S04 VALVE HOUSING PORTS)   |
| 303   | 1   | OLDHAMS COUPLING           | 476   | 5   | BACK-UP RING (CYLINDER END CAP)    |
| 305   | -   | SHIM (STEEL)               | 482   | 1   | O-RING (VALVE HOUSING SURROUND)    |
| 401   | 1   | REAR BEARING               | 483   | 5   | PISTON SEAL BACKING RING           |
| 402   | 1   | FRONT BEARING              | 484   | 1   | CUSTOMER KEY                       |
| 404   | 5   | PISTON SEAL RING           | 487 * | 1   | PLASTIC PLUG                       |
| 405   | 12  | VALVE SEAL RING            | 498   | 5   | O-RING RETAINER (LONG)             |

|                                                                 |                       |          |                                                              |
|-----------------------------------------------------------------|-----------------------|----------|--------------------------------------------------------------|
| THIRD ANGLE PROJECTION                                          | NAME                  | DATE     | <br><small>Emesette, Plymouth PL5 2SA www.kpm-eu.com</small> |
|                                                                 | DR: M.NORMAN          | 20.05.09 |                                                              |
|                                                                 | CHK: F.STANTON        | 01.09    |                                                              |
|                                                                 | ENGR. APPL: F.STANTON | 01.09    |                                                              |
| TITLE<br>GENERAL ASSEMBLY (FOR SPARES)<br>HMB030/045 2 PT MOTOR |                       |          | SHEET<br>016502<br>1 of 1                                    |

ALL TECHNICAL DATA DISCLOSED HEREIN IS THE PROPERTY OF KAMASAKI AND SHALL NOT BE USED BY OTHERS FOR MANUFACTURE, PROCUREMENT OR DISCLOSURE WITHOUT THE WRITTEN PERMISSION OF THE OWNER.