

DRAWING No. 016392

ISSUE	CHANGE	DATE	CHK
A		04.08	
B		01.12	FS

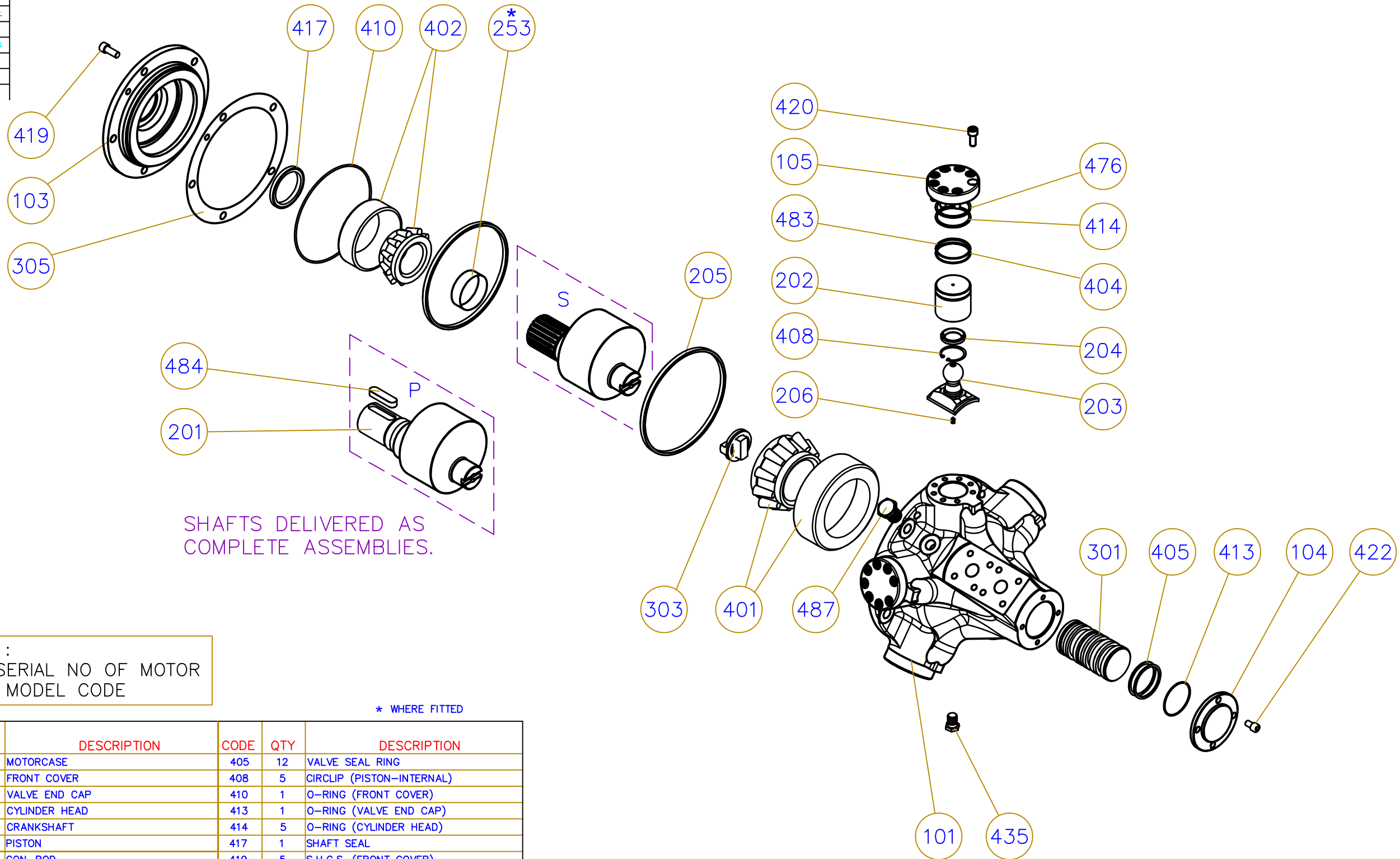

SPARES :
QUOTE SERIAL NO OF MOTOR
+ FULL MODEL CODE

* WHERE FITTED

CODE	QTY	DESCRIPTION	CODE	QTY	DESCRIPTION
101	1	MOTORCASE	405	12	VALVE SEAL RING
103	1	FRONT COVER	408	5	CIRCLIP (PISTON-INTERNAL)
104	1	VALVE END CAP	410	1	O-RING (FRONT COVER)
105	5	CYLINDER HEAD	413	1	O-RING (VALVE END CAP)
201	1	CRANKSHAFT	414	5	O-RING (CYLINDER HEAD)
202	5	PISTON	417	1	SHAFT SEAL
203	5	CON-ROD	419	5	S.H.C.S. (FRONT COVER)
204	10	PISTON RETAINING HALF RING	420	40	S.H.C.S. (CYLINDER END CAP)
205	2	CON-ROD RETAINING RING	422	4	S.H.C.S. (VALVE END CAP)
206	5	RESTRICTOR SCREW	435	2	DRAIN PLUG
253 *	1	SHAFT SLEEVE	476	5	BACK-UP RING (CYLINDER END CAP)
301	1	VALVE SPOOL	483	5	PISTON SEAL BACKING RING
303	1	OLDHAMS COUPLING	484	1	CUSTOMER KEY
305	-	SHIM (STEEL)	487	1	PLASTIC PLUG
401	1	REAR BEARING			
402	1	FRONT BEARING			
404	5	PISTON SEAL RING			

THIRD ANGLE PROJECTION	NAME	DATE	
	DR. M.NORMAN	17.04.08	
	CHK.		
	ENGR. APPL.		TITLE
	WT.		GENERAL ASSEMBLY (FOR SPARES)
			HMB010 MOTOR
<small>ALL TECHNICAL DATA DISCLOSED HEREIN IS THE PROPERTY OF KPM/STAFFA AND SHALL NOT BE USED BY OTHERS FOR MANUFACTURE, PROCUREMENT OR DISCLOSURE WITHOUT THE WRITTEN PERMISSION OF THE OWNER.</small>			SIZE A1 SCALE NTS DRAWING No. 016392 SHEET 1 of 1